

1A

**Site at back of
'Morning Star'
Triq Ganni Vassallo
RABAT (Ghawdex)**

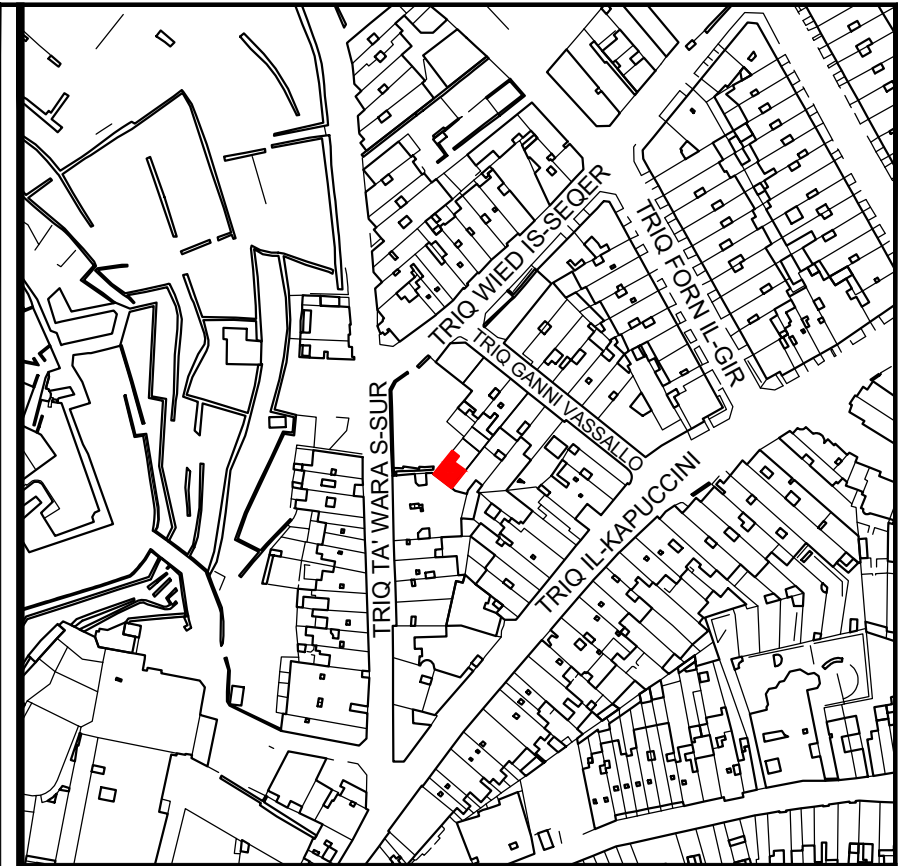
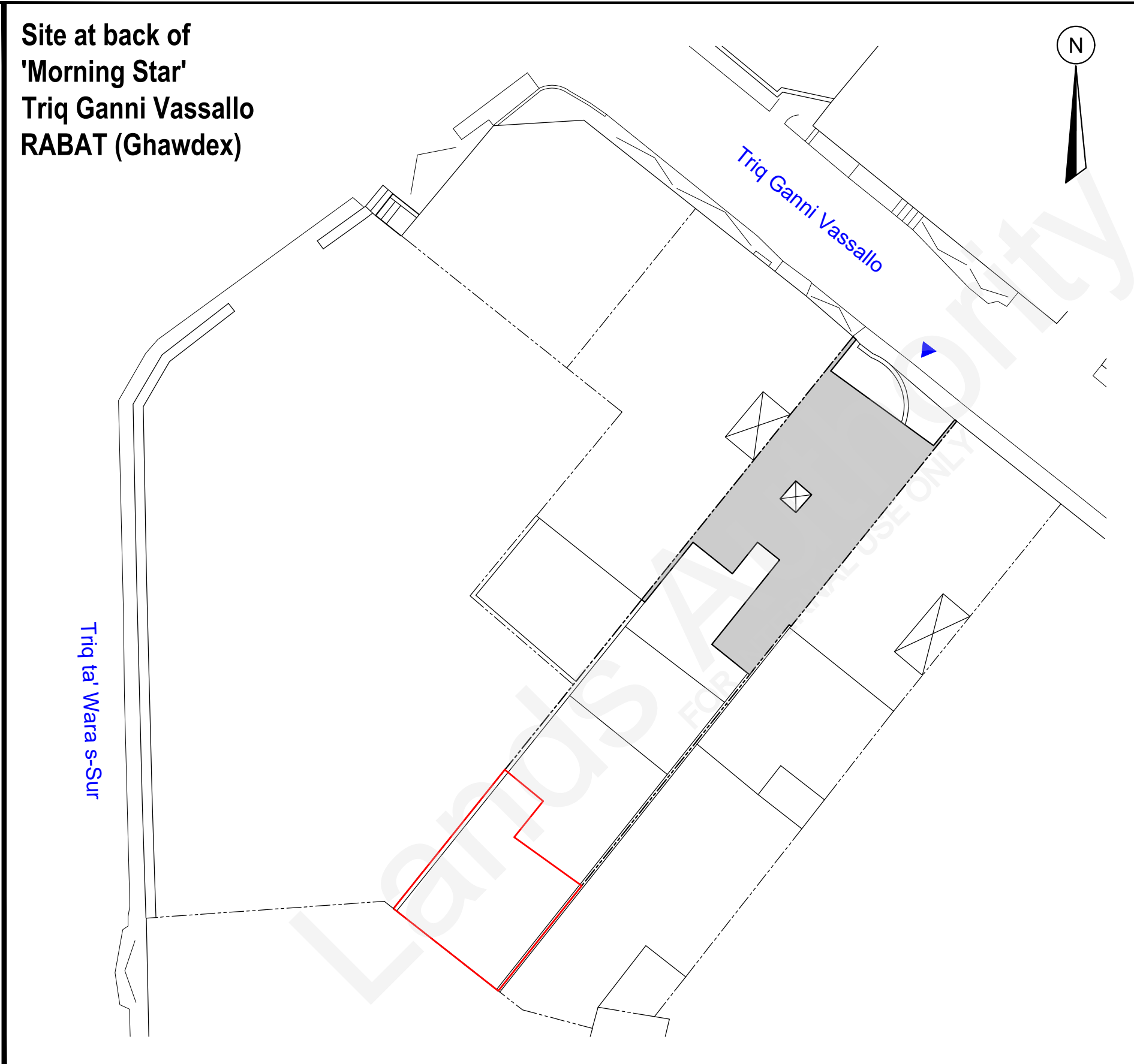
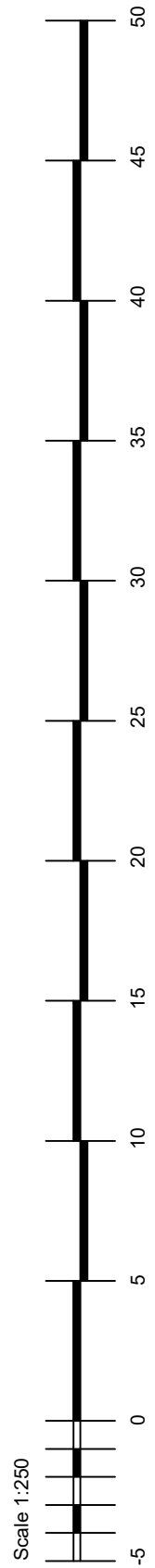

Site Plan
S.S. 3089

Scale 1:2500
Map Ref.: 31769
89567

Property No : **E270977**
Area : **60.4m²**



Auberge de Baviere
St. Sebastian Str, Valletta
Phone (00356) 2295 3238/39/40/42
Website landsauthority.org.mt

Estate Management & Business Development

Locality: RABAT (Ghawdex)	
P.D. No.: 2022_0416	Scale : 1 : 250
File No.: L/0175/2022	Drawn by : bugem151

A&CE sgd (S. Scotto)

Date : **23rd June, 2022**



Extent interpreted from Government Property Registration.