

17A

**Premises No.48
Triq San Duminku
VALLETTA**

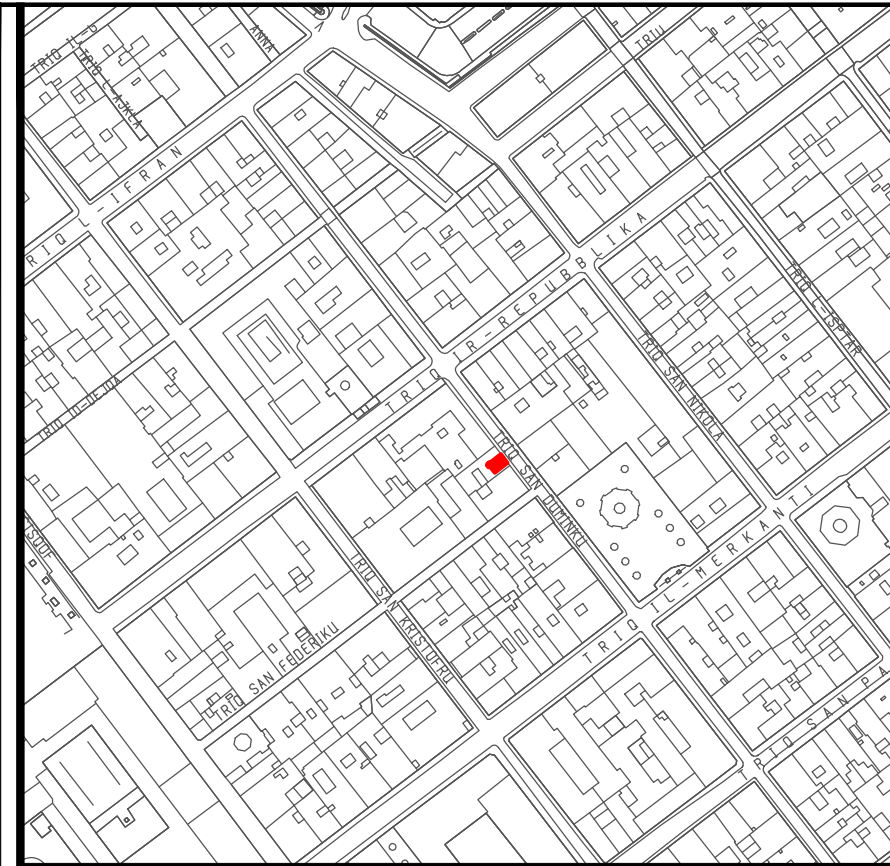
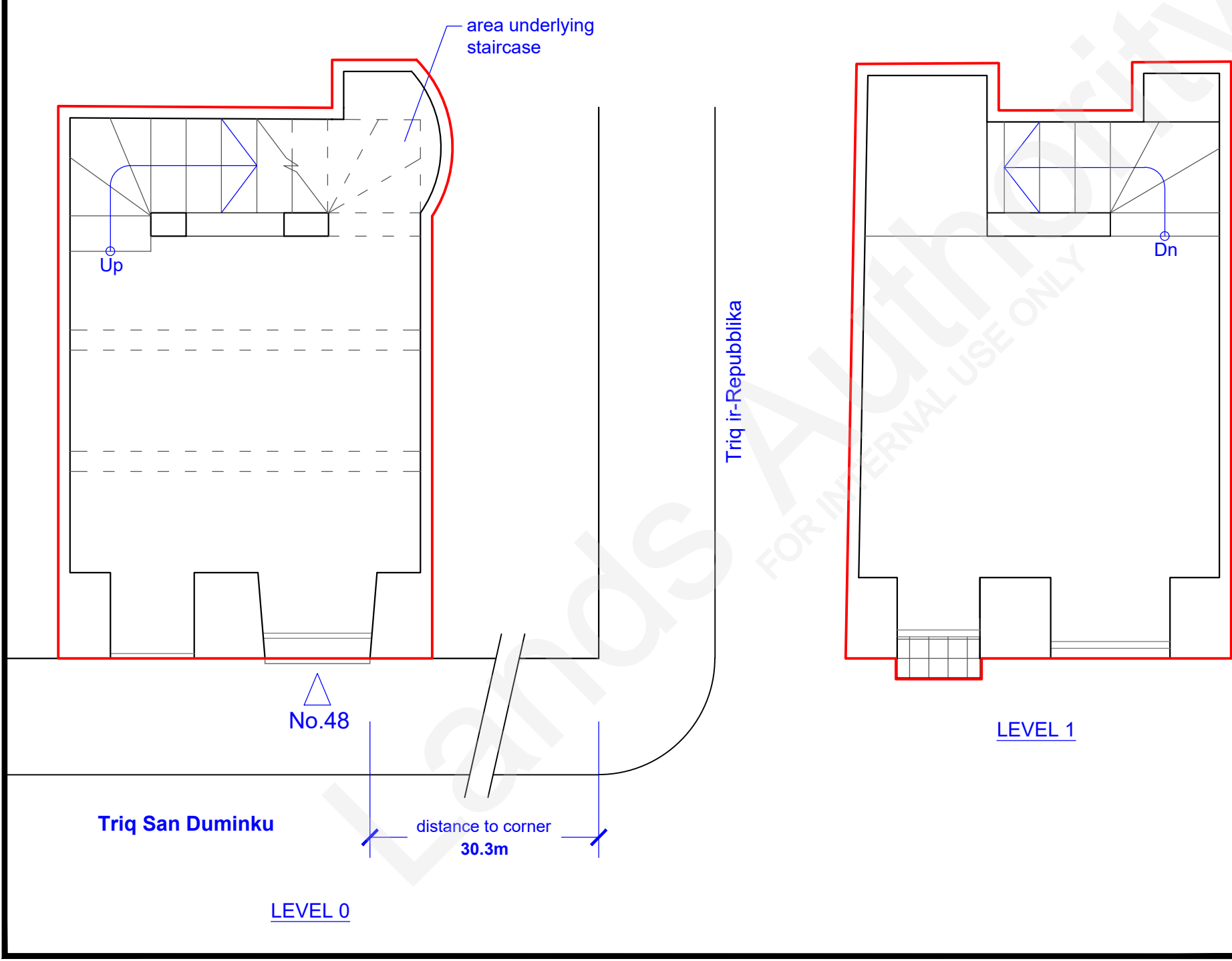
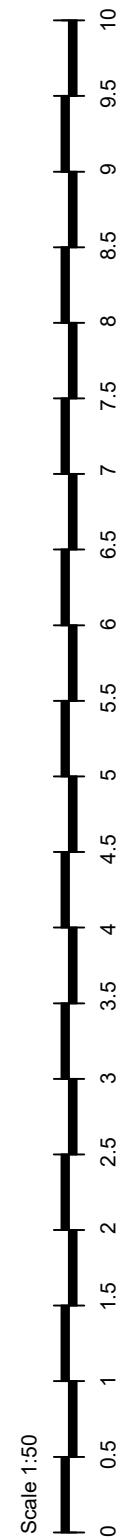
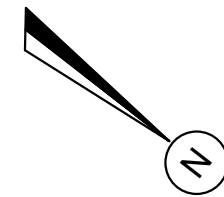

Site Plan
S.S. 5673

Scale 1:2500
Map Ref.: 56337
73135 (ED50)

456280
3972938 (WGS84)

Property No : **J62610**
Area Level 0 : **20.8m²**
Area Level 1 : **21.7m²**

LANDS Authority
Estate Management & Business Development

Auberge de Baviere
St. Sebastian Str, Valletta
Phone (00356) 2295 3238/39/40/42
Website landsauthority.org.mt

Locality: VALLETTA	
P.D. No.: 2024_0751	Scale : 1 : 50
File No.: R/0587/1997	Drawn by : tonns022
A&CE sgd (S. Scotto)	f/ Chief Officer Estate Management & Business Development sgd (R. Demicoli)
Date : 5th July, 2024	Date : 5th July, 2024

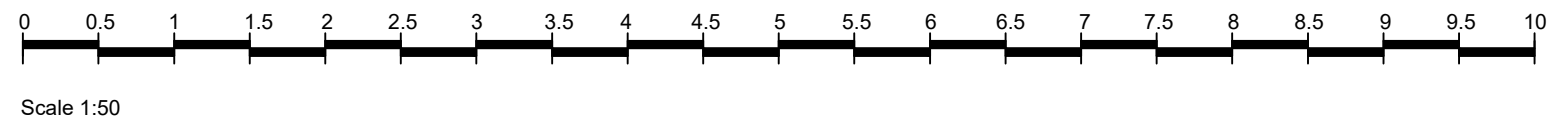

Extent checked and measured on-site in July 2024.