

# STRUCTURE AT QAWRA POINT I/O SAN PAWL IL - BAHAR

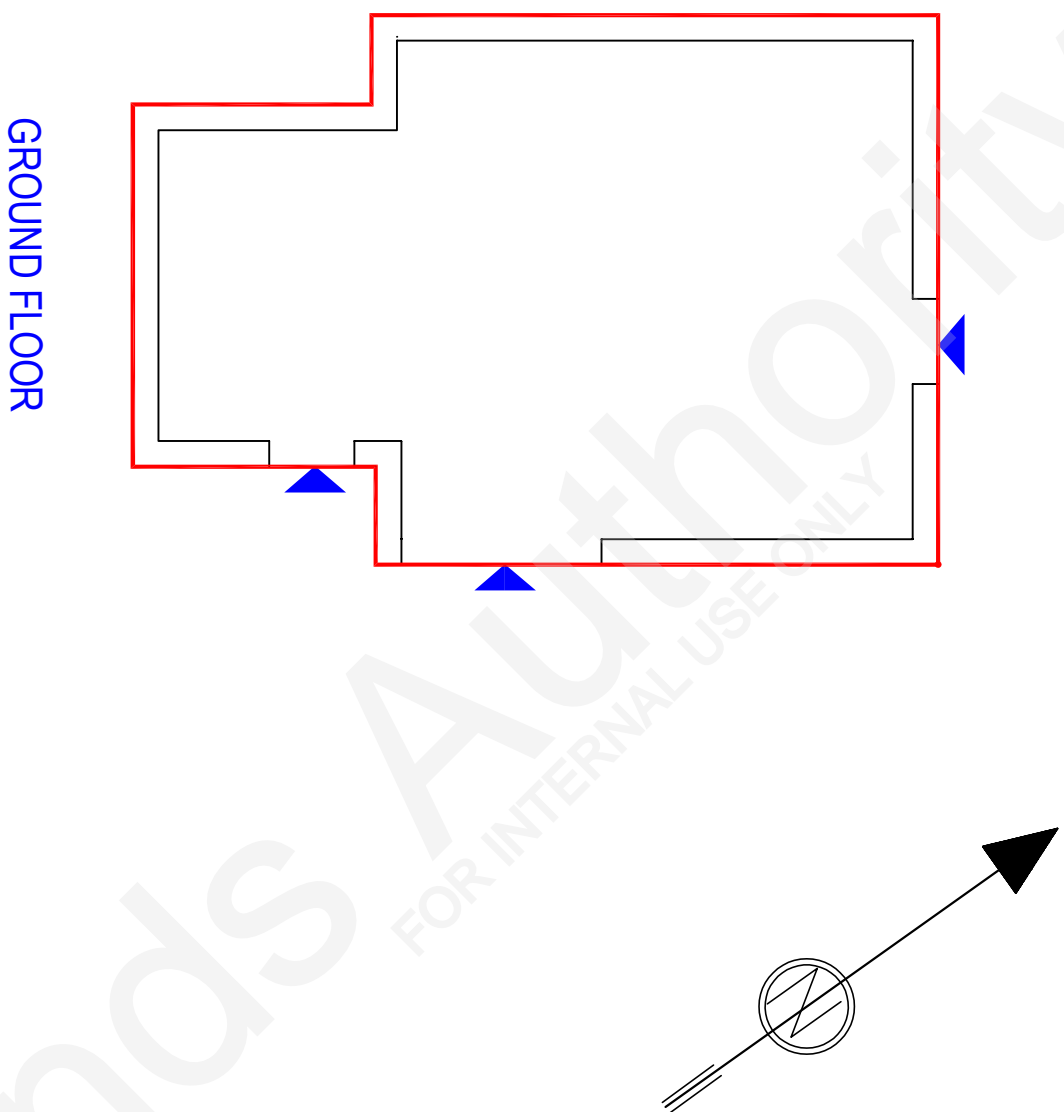

SCALE 1 : 100

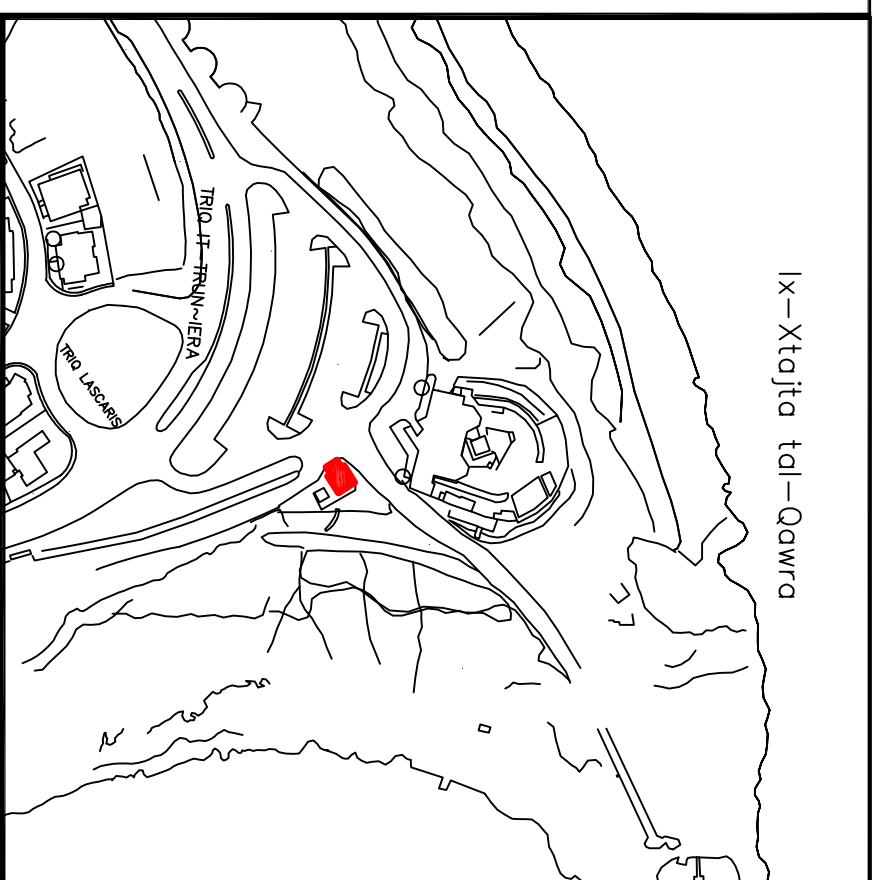
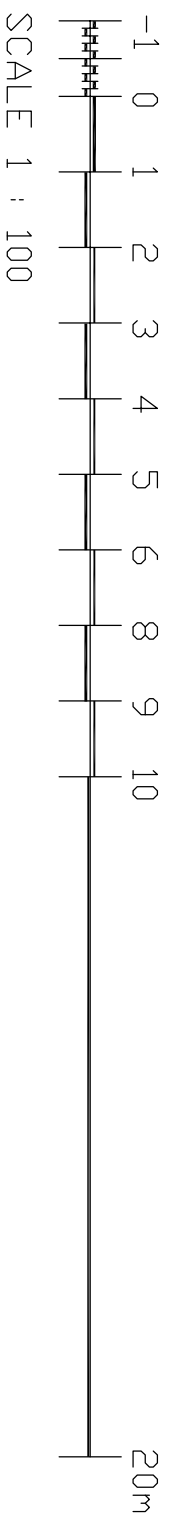
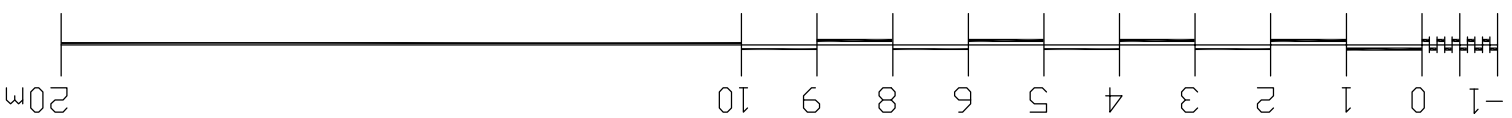

PROPERTY No. : 94782  
AREA 55 m<sup>2</sup>  
Without Airspace



Estate Management & Business Development

Locality: **SAN PAWL IL-BAHAR**

P.D.No.: **71\_65\_1** Scale : **1 : 100**

File No.: **L825/63/1** Drawn by : **mamoj009**

(Sgd. S. Scotto)

(Sgd. R. Demicoli)

A&CE  
Date : **24th August 2018**

f/Chief Officer - Estate Management  
& Business Development  
Date : **24th August 2018**

Auberge de Baviere  
St. Sebastion Str. Valletta  
Phone (00356) 2295 3238/39/40/42  
Website  
landsauthority.org.mt