

6A

### 3 Rooms at Level -1 Accessed from Premises No. 13 Triq Mikiel Anton Vassalli VALLETTA

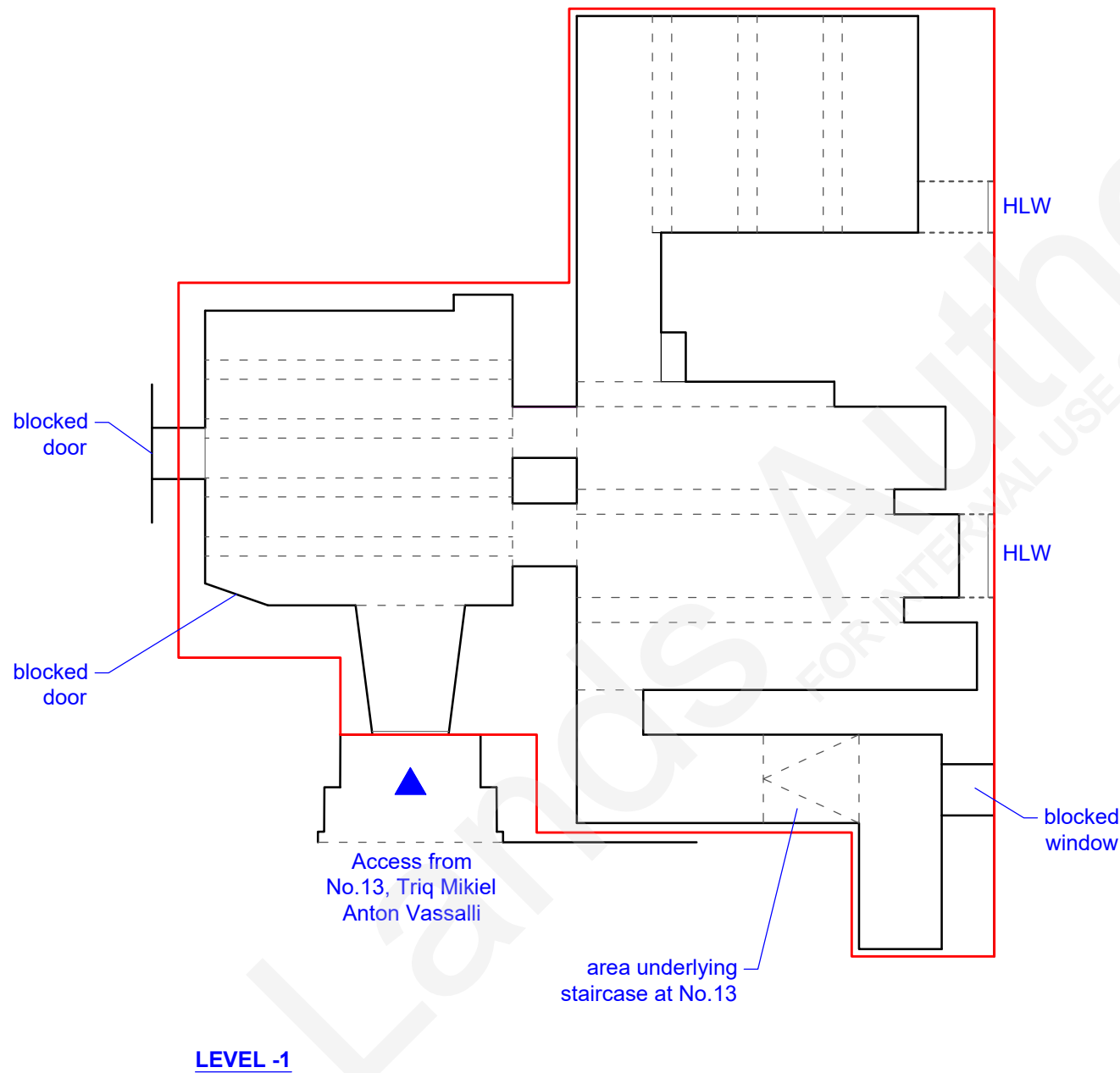
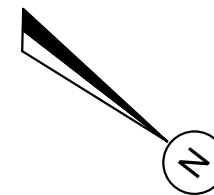

LEVEL -1

TRIQ MIKIEL ANTON VASSALLI  
(at Level 0)

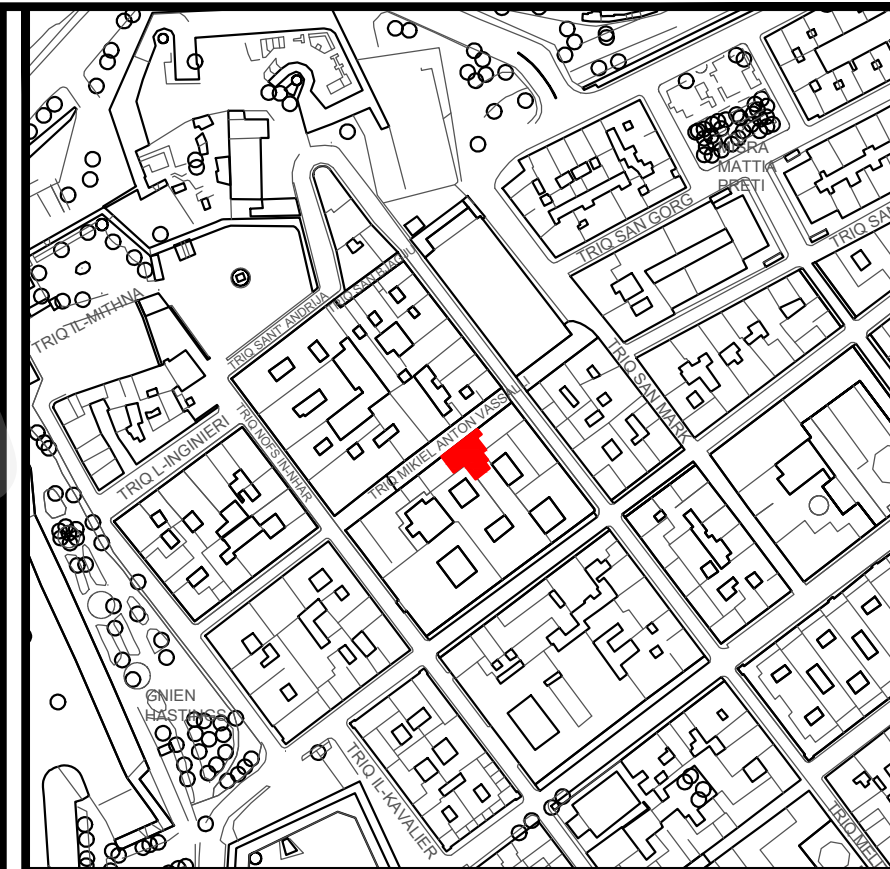

Site Plan  
S.S. 5573

Scale 1:2500  
Map Ref.: 55765  
73012

Property No : E271198  
Area : 130.4m<sup>2</sup>



Auberge de Baviere  
St. Sebastian Str, Valletta  
Phone (00356) 2295 3238/39/40/42  
Website landsauthority.org.mt

Estate Management & Business Development

Locality: <b>VALLETTA</b>	
P.D. No.: <b>2022_0530</b>	Scale : <b>1 : 100</b>
File No.: <b>L/0701/1962/0012</b>	Drawn by : <b>bugem151</b>

A&CE **sgd (S. Scotto)**

Date : **26th August, 2022**

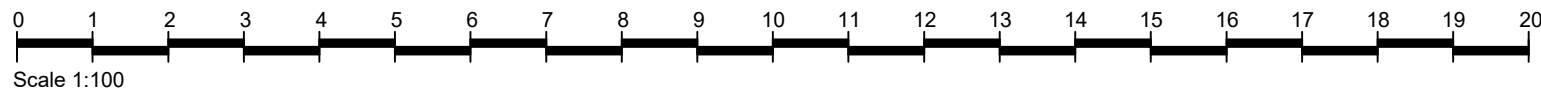

Extent interpreted from drawing submitted by Applicant and Public Works drawing. Premises checked on-site in August 2022.