

12A

**SITE BETWEEN
TRIQ L-IMREJKBA AND
TRIQ IL-FLIEGU,
SAN PAWL IL-BAHAR.**

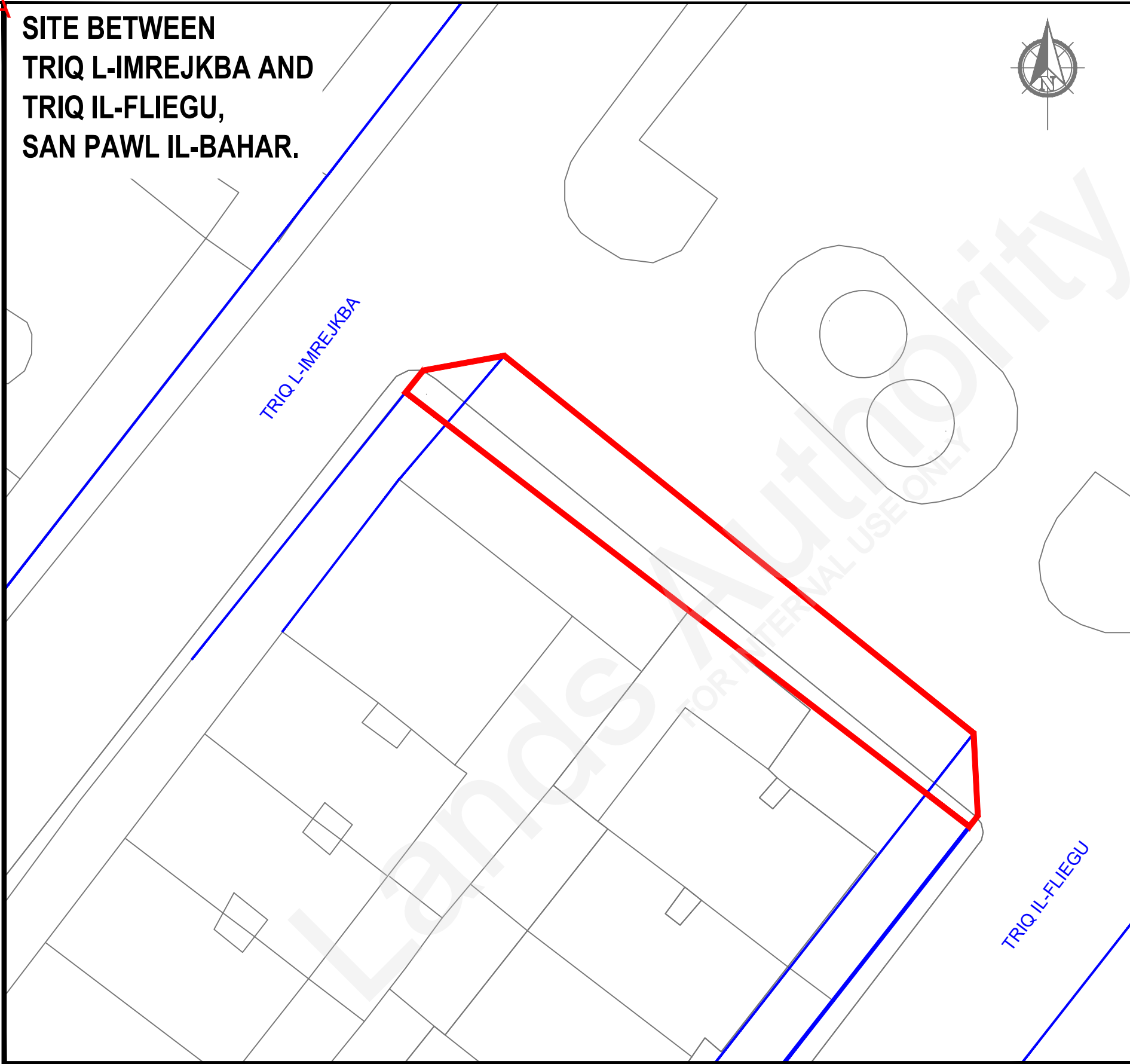

SCALE 1 : 250



SCALE 1 : 250

SITE INTERPRETED FROM GOVERNMENT LAND REGISTRATION AND FROM PLANNING AUTHORITY INDICATIVE BUILDING ALIGNMENT.

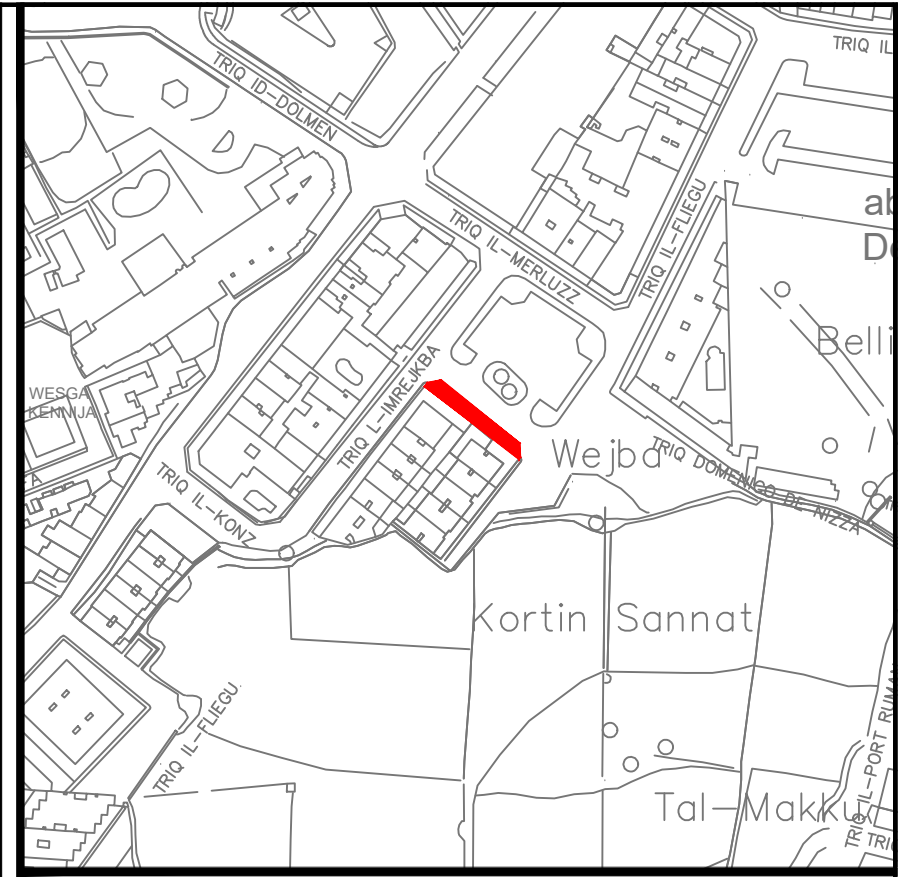

Site Plan
S.S. 4679

Scale 1:2500
Map Ref.: 47691
79044

-  Property No : E20491
Area : 170m²
-  Planning Authority indicative building alignment.

 <p>LANDS Authority</p> <p>Auberge de Baviere St. Sebastian Str, Valletta Phone (00356) 2295 3238/39/40/42 Website landsauthority.org.mt</p> <p>Estate Management & Business Development</p>	
Locality: SAN PAWL IL-BAHAR	
P.D. No.: 2008_275_A	Scale : 1 : 250
File No.: L/0595/1968/0002	Drawn by : cianj014
(sgd. J. Schembri)	
A&CE	
Date : 06 th July 2022	