

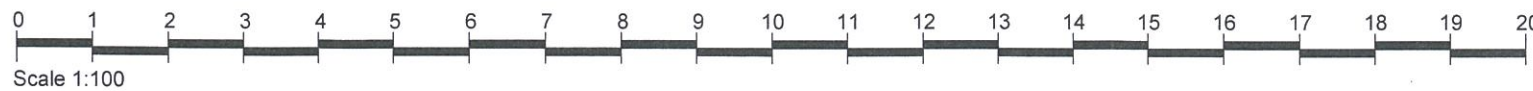

**Site at  
Triq Ghajn Tuta  
IL-FONTANA (Ghawdex)**

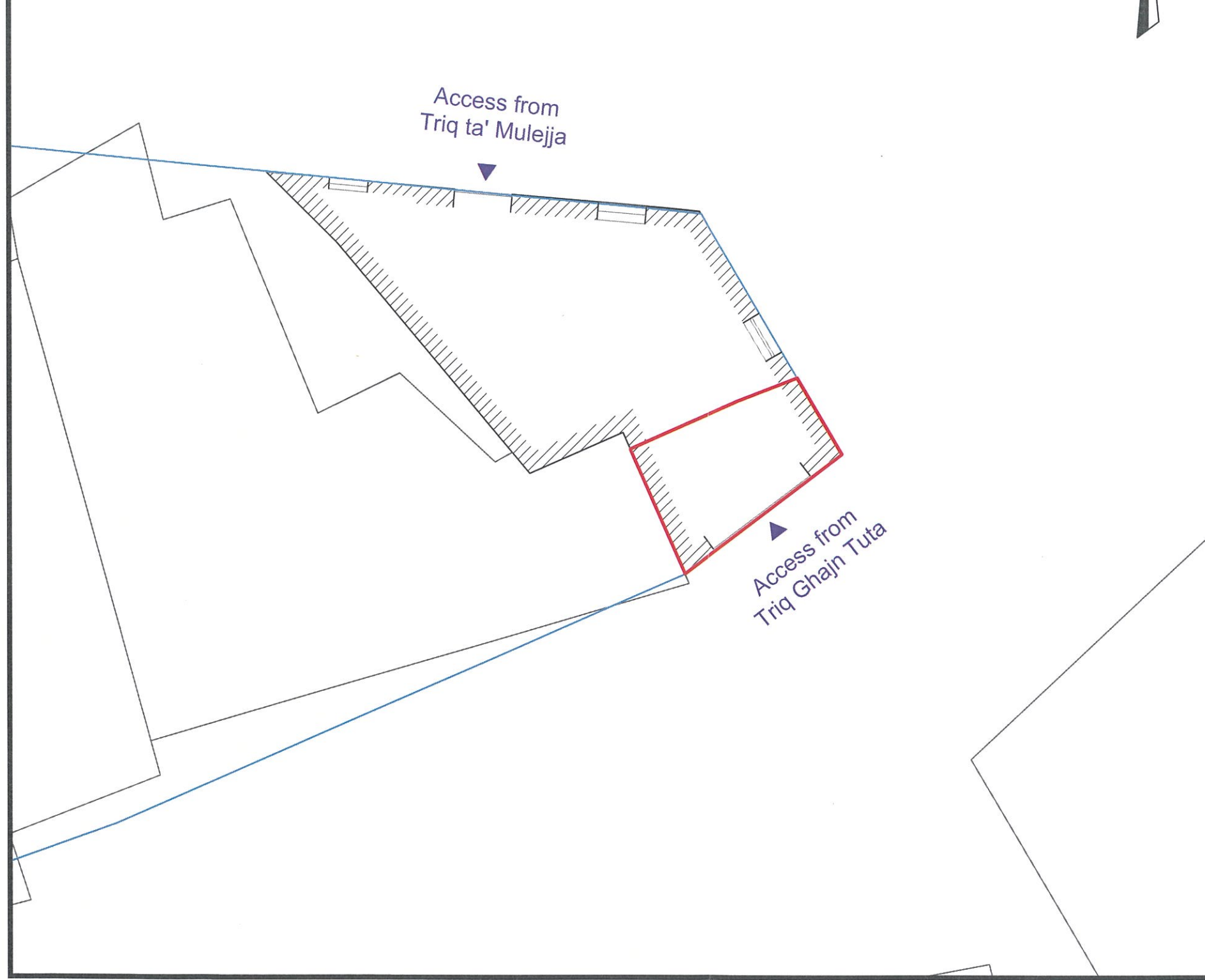
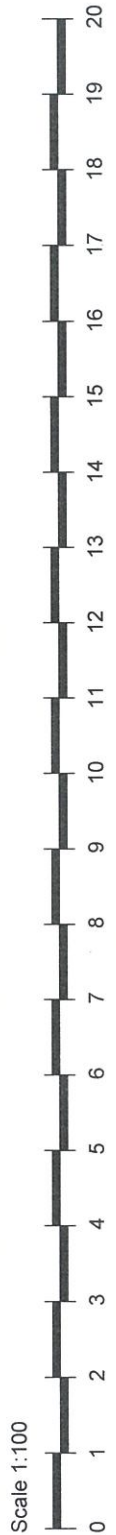

Site Plan  
S.S. 3088

Scale 1:2500  
Map Ref.: 31135  
88580

 Property No : E270239  
Area : 9.2m<sup>2</sup>

 Scheme Alignment Interpretation  
as established by  
the Planning Authority



Auberge de Baviere  
St. Sebastian Str, Valletta  
Phone (00356) 2295 3238/39/40/42  
Website landsauthority.org.mt

**Estate Management & Business Development**

Locality: **IL-FONTANA (Ghawdex)**

P.D. No.: **2021\_0014** Scale : **1 : 100**

File No.: **L 520/2020** Drawn by : **bugem151**

A&CE **sgd (S. Scotto)**

Date : **14th April 2021**

Extent is interpreted from drawing submitted by Architect (see Plan T036-02 Dwg. No.1 - see Red 1H(f) in File No. L 520/2020) and Land Registration.  
The Scheme Alignment Interpretation conforms with survey submitted by the Planning Authority as approved in PC 29/07 (see Red 8 in File No. L 520/2020).